

# CHARMILL

RESIDENTIAL



Randolph Avenue, Little Venice W9

£415 Per week



# Randolph Avenue



## Description

This one bedroom apartment is situated on the second floor of a period building and comprises an open plan kitchen/reception room with wooden flooring, spacious double bedroom with storage and an en-suite shower room. The property is ideally located opposite Paddington Recreation Ground and is 0.1 miles away from Maida Vale Underground Station (Bakerloo Line) as well as being close by to the cafes, pubs and boutique shops on Elgin Avenue.

- Open plan kitchen/reception room
- Shower room
- Wooden flooring
- Spacious principal bedroom
- Permit parking
- Well-located





## Floor Plan

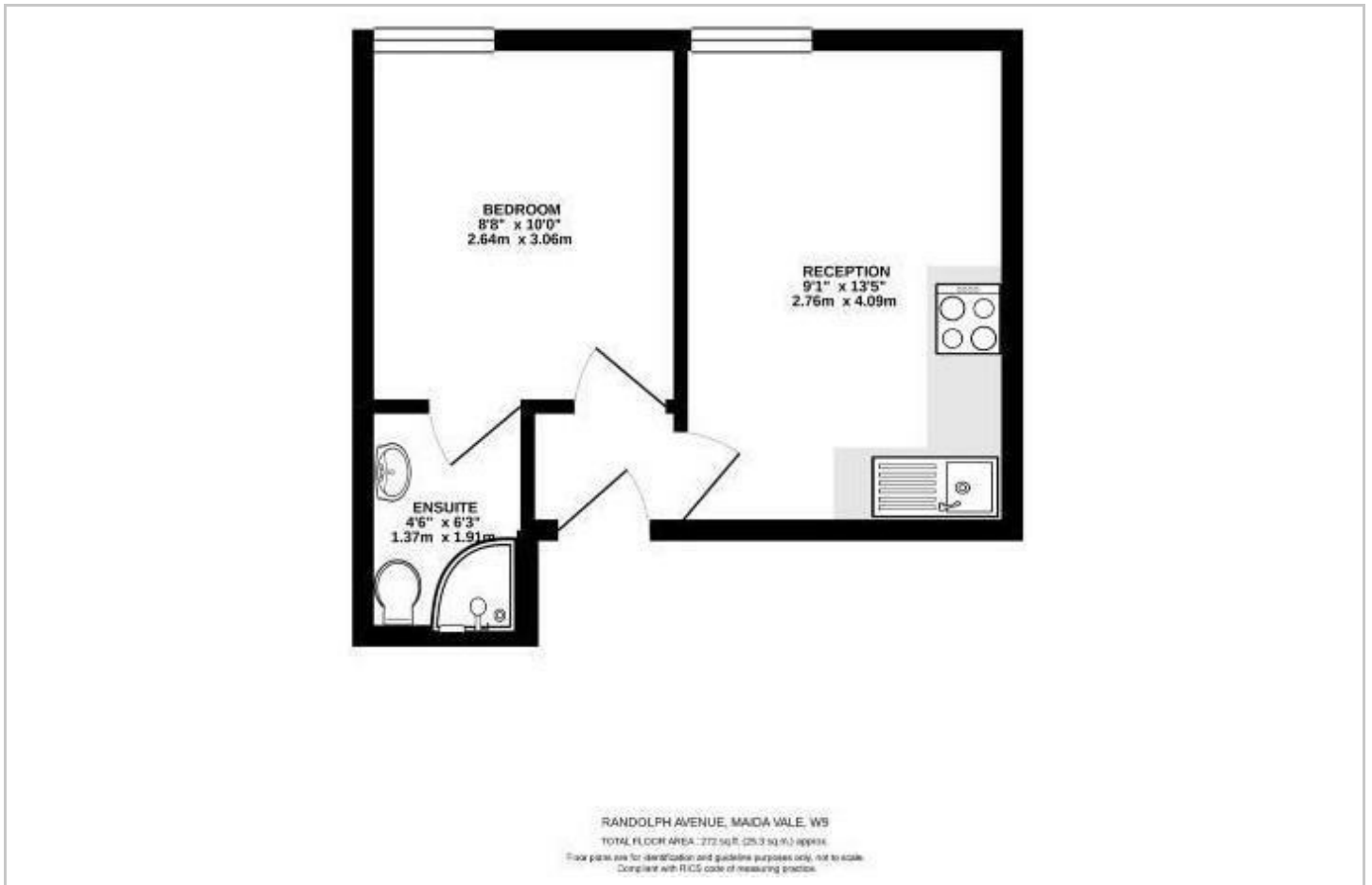

## Area Map

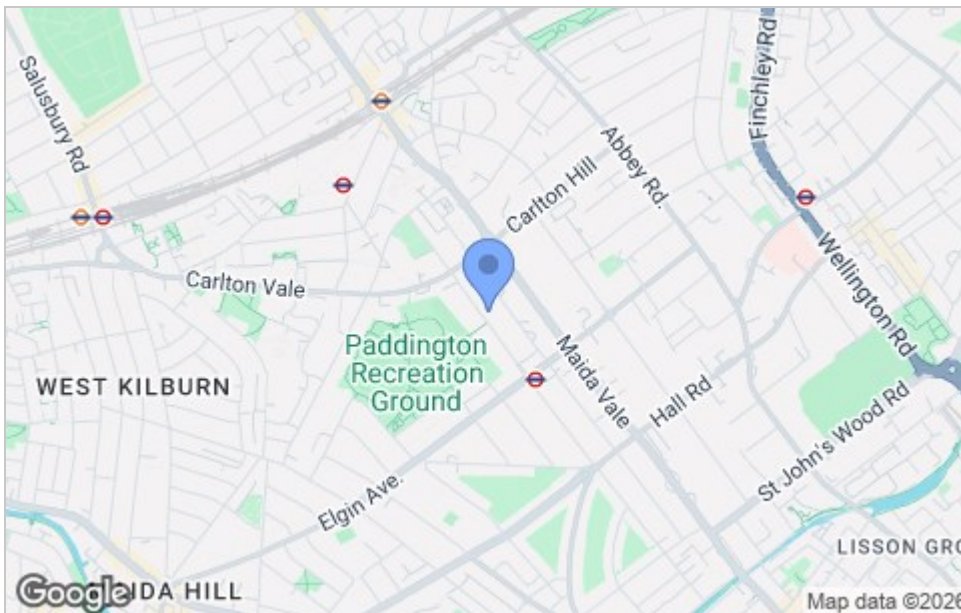

## Viewing

Please contact us on 020 7046 6275 if you wish to arrange a viewing appointment for this property or require further information.

## Energy Efficiency Graph

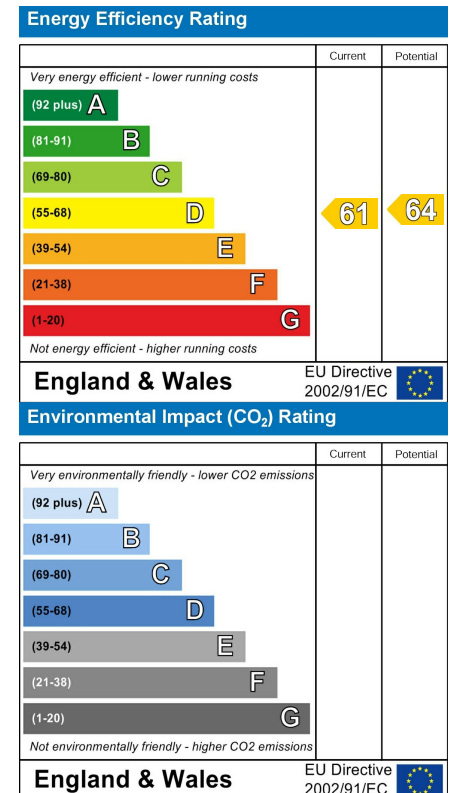

These particulars, whilst believed to be accurate are set out as a general outline only for guidance and do not constitute any part of an offer or contract. Intending purchasers should not rely on them as statements of representation of fact, but must satisfy themselves by inspection or otherwise as to their accuracy. No person in this firm's employment has the authority to make or give any representation or warranty in respect of the property.

020 7046 6275 • sales@charmillresidential.co.uk • 51 Maida Vale, Little Venice, London W9 1SD  
 charmillresidential.co.uk